

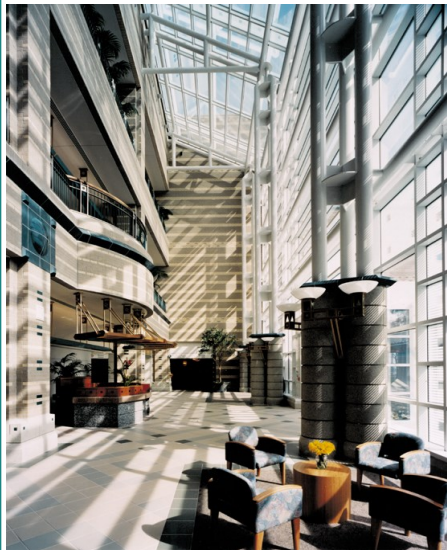

San Joaquin General Hospital is recruiting for

CLINICAL NURSE SPECIALIST - FMC

THE POSITION



The Clinical Nurse Specialist is a key member of the Family Maternity Center professional staff and functions in an advisory and teaching capacity at San Joaquin General Hospital. This position provides technical expertise and assistance in developing and maintaining standards of care within areas of clinical expertise by planning and implementing specialized clinical instruction programs for nursing staff, and by participating in the development of policies and procedures. This position works closely with physicians and interprets and relays treatment plans to nursing staff.

THE DEPARTMENT

San Joaquin General is a community hospital and designated Level III Trauma Facility located in French Camp, CA and has approximately 1,600 employees. The hospital is in need of a Clinical Nurse Specialist who is looking for exciting, fulfilling position with a comprehensive interdisciplinary team. There is one vacancy in the Family Maternity Center. The department includes Labor & Delivery, Nursery and Post-Partum units. The ideal candidate will have excellent interpersonal communication skills, ability to mentor role competent nursing practices, and administer professional presentations to staff and the community. Our hospital includes:

- 12 beautiful LDRP suites
- Perinatologist Service
- OB Anesthesia 24/7
- OB coverage for emergencies
- Midwives Service 24/7
- Outreach Education Resources

***Our community's health and well-being are our highest priority!
Come learn, share and grow with us!***



CLINICAL NURSE SPECIALIST - FMC

TYPICAL DUTIES

- Determines need for clinical education in area of specialty; provides clinical education programs through presentations, community education, and/or in-service sessions; provides orientation for new nursing personnel; organizes and directs nursing rounds and teaching of nursing staff; plans, organizes, implements, and participates in outreach educational programs for community hospitals.
- Acts as liaison between the nursing division and medical staff, outside agencies, and affiliated universities; attends meetings; participates on committees; participates in professional organizations to maintain level of expertise in clinical specialty; may speak before community groups regarding area of clinical specialty.
- Consults with patient care team members to coordinate the intra-area delivery of nursing care, including planning patient care prior to admission and after discharge or transfer to another nursing care area.
- Participates in development of policies and procedures within area of specialty; keeps records; reviews current literature, conducts research, attends seminars and maintains membership in professional organizations; uses performance improvement model to improve advanced clinical practice and care; writes reports; prepares handbooks and other informative literature.
- Coordinates and participates in the delivery of patient care in a specialized nursing unit; assesses and intervenes in complex health care problems within clinical specialty area; selects, uses and/or evaluates technology, products, and devices appropriate to specialty area; manages populations of clients with disease states and non-disease based etiologies to improve and promote health care outcomes.
- Provides clinical expertise and performs consultative functions in multiple health care settings; makes recommendations in area of clinical specialty to health care professionals, patients, and health care organizations; uses evidence-based clinical practice to develop methods to improve patient care and patient care outcomes.
- Provides clinical leadership; demonstrates and implements mastery in related clinical theories, professional development, and changes affecting the profession and the community.

About San Joaquin County

San Joaquin County is an extraordinary place to work and live. A land of beauty, recreation and natural riches— from the waters of the Delta to the vines of the wine, San Joaquin County has it all. San Joaquin County boasts seven cities and some of the finest opportunities in the state for boating, fishing, camping, history-gathering, or just plain fun in the sun. Each city, as well as the unincorporated county areas, offers a unique opportunity to enjoy natural California beauty nature, music, arts and culture. Whatever your interest, it can most likely be found in San Joaquin County.

CLINICAL NURSE SPECIALIST - FMC

COMPENSATION AND BENEFITS

Annual Base Salary: \$114,067-\$138,632

(Approx Monthly Salary: \$9,505-\$11,552)

In addition to the above base salary, the County offers an excellent benefits plan which includes a county contribution to health insurance, dental and vision insurance plans. Other benefits also offered by the County include:

- ♦ 1937 Retirement Act plan with reciprocity with CALPERS
- ♦ 125 Flex Spending Benefits Plan
- ♦ 12 days sick leave annually with unlimited accumulation
- ♦ 15 days of vacation leave up to 10 years, 20 days after 10 years, and 23 days after 20 years)
- ♦ 10 holidays per year
- ♦ 125 Flex Benefits Plan

APPLICATION SUBMITTAL PROCESS

Resumes will not be accepted in lieu of an application. This position is open **Until Filled**. Application materials may be obtained from and submitted to:

San Joaquin County Human Resources
44 N. San Joaquin Street Suite 330
Stockton, CA 95202
Tel: 209.468.3370
Apply Online Today At:
www.sjgov.org/departments/hr

MINIMUM QUALIFICATIONS

Note: Supplemental application must be submitted with regular employment application.

Education: Possession of a master's degree in nursing which meets the State of California Clinical Nurse Specialist requirements.

Experience: Two years full time experience as a registered nurse.

Special Requirement: Nursing experience required in area of clinical nurse specialization, depending on the area of assignment.

License & Certificate:

1. Valid certification as a Clinical Nurse Specialist issued by the State of California.
2. Current registration as a nurse in the State of California.
3. Possession of a valid California driver's license.





CLINICAL NURSE SPECIALIST - FMC Supplemental Questionnaire

Submit responses to the following questions along with your employment application to the San Joaquin County Human Resources Division. Please number your responses, address each question separately, and limit - one page per question. Please provide detailed descriptions of your experience. These questions will be reviewed in evaluating your qualifications.

1. Do you possess a master's in nursing which meets the State of California Clinical Nurse Specialist requirements? ____Yes ____No

If yes, identify the name of college or university in which you obtained your Master's in Nursing.

2. Do you possess at least two years full time experience as a registered nurse in an acute care facility's Maternity/Labor & Delivery Department? ____Yes ____No

If yes, describe the advanced nursing duties you performed in the Family Maternity Department. Include in your answer the following:

- The name of the hospital facility
- Your position title
- Number of years in the department
- Number of staff you trained or precepted in the department
- Number of staff you supervised or evaluated in the department

3. Do you possess the following:

- Valid certification as a Clinical Nurse Specialist issued by the State of California? ____Yes ____No

If yes, identify your Clinical Nurse Specialist Certification as issued by the State of California.

- Valid Registered Nursing license in the State of California? ____Yes ____No

If yes, identify your RN license number and expiration date.

4. Do you possess a valid California Driver's license? ____Yes ____No

If yes, identify your CDL number and current expiration date.

5. Do you currently possess experience as a Clinical Nurse Specialist in an Family Maternity Department? ____Yes ____No

If yes, provide a detailed description of the duties you performed while in that role.